

Replacement Parts List

P/N: 068-521-060-009 (903165) Sensor, Length/Angle 521/09

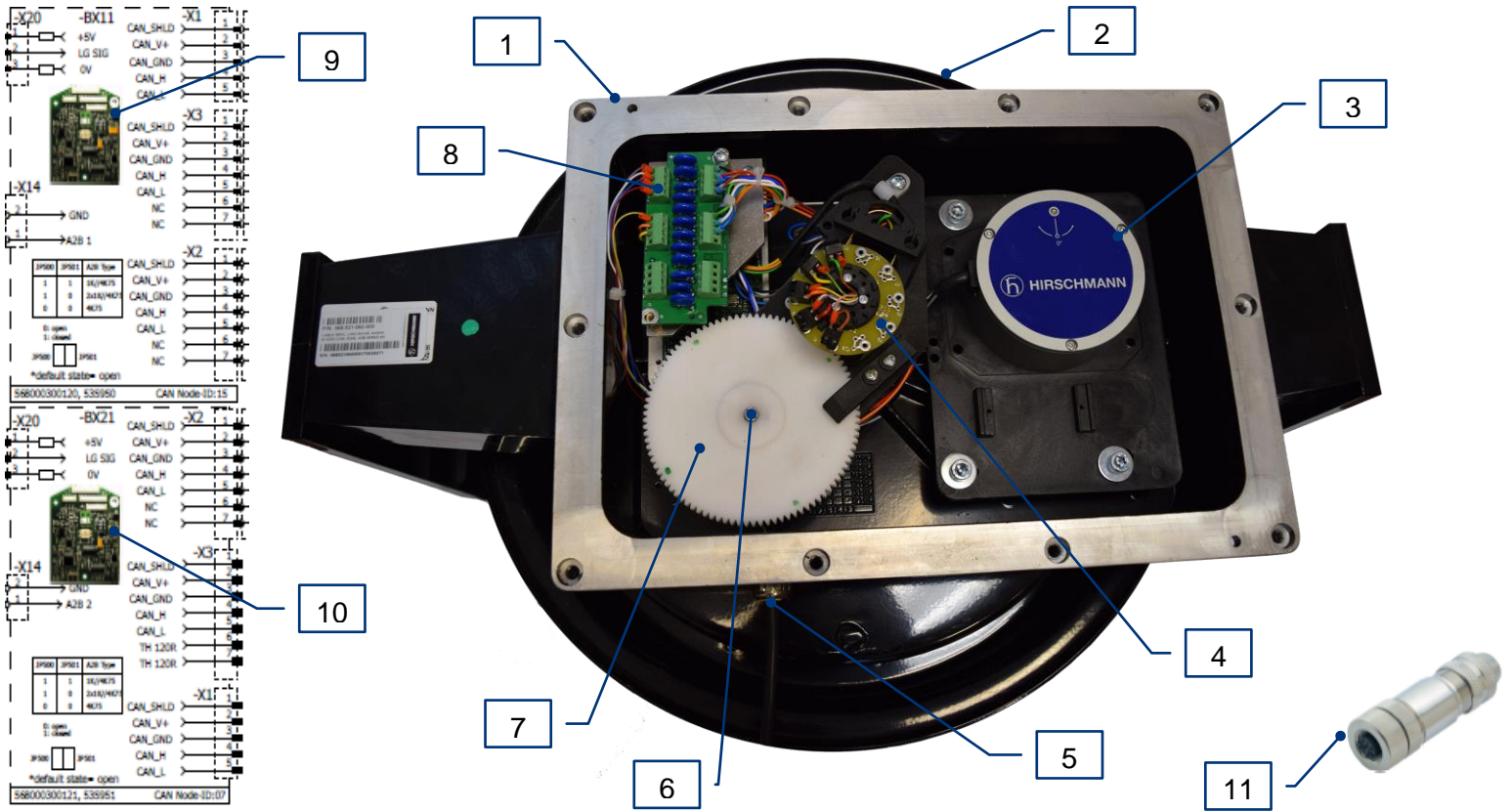

#	Part #	SAP #	Qty	Description
1	068-521-100-001	536768	1	Cable Reel Housing, w/ Spring,Drum,Cover,Mounting Arms
*1.1	068-000-100-196	527470	1	Cable Reel Accy, Cover with Screws
*1.2	068-000-050-203	527485	1	Cable Reel Accy, Drum Only
*1.3	068-000-050-197	527473	1	Cable reel Mounting Arm Bracket (Left)
*1.4	068-000-050-198	527474	1	Cable Reel Mounting Arm Bracket (Right)
*1.5	000-205-031-230	n/a	4	Screw, 12mmx30mm Hex Head (Mounting Bracket Arm)
*1.6	000-208-020-012	n/a	4	Washer, Lock, 12mm Tooth (Mounting Bracket Arm)
2	000-673-060-014	311036	197'	Cable, Length 6 Core (Sold by the foot)
3	064-360-061-551	606700	1	Sensor, Angle WGC360/1551
4	068-000-110-163	537443	1	Slipring, 5 Conductor
5		537155	1	Cable Reel Accy, Cable Assembly Connection
6		532082	1	Sensor, Length Pot 203 OVW 300MM 067-000-100-203
7	067-000-050-126	n/a	1	Gear Wheel, 96 Tooth
8	068-000-300-095	536933	1	Board, Terminal Connection
9		535950	1	Board, Length & A2b CAN 068-000-300-120
10		535951	1	Board, LS-0121, 1XLS a2B & 2XCAN 068-000-300-121
11		531737	1	Connector, M12,5POLE, SOC, Straight (Length Cable)

* Item not illustration; ¥ Exchanged only by an authorized WIKAL Mobile Control Representative

WIKAL Mobile Control
1540 Orchard Drive, Chambersburg, PA 17201

Service: (717) 217-2250
Parts / Sales: (717) 217-2269
www.wika-mc.com

Document Reference: 068-521-060-009_-02

WIKAL Mobile Control reserves proprietary rights to this document and to the data shown there on. The drawing and data are confidential and are not to be used or reproduced without the written consent of WIKAL Mobile Control. This drawing is subject to technical modification without prior notice.